

Technical drawing of a rectangular structure, possibly a foundation or a platform, with dimensions and annotations. The structure is shown in perspective, with a top view and a side view. The top view is a rectangle with a width of 3,00 and a depth of 3,00. The side view shows a height of 0,30. The structure is divided into three horizontal sections: a top section with a cross-hatched pattern, a middle section with a diagonal hatched pattern, and a bottom section with a dotted pattern. The structure is supported by four circular bases, each with a square base and a triangular support. The drawing includes various dimension lines and annotations, such as 3,00, 0,30, 0,60, and 0,60. The drawing is labeled with 'a)' in the top left corner.

Schranke A1 - QI/QIV  
Fa. Raibefon  
Schranke ohne Behang (Länge 3-6 m)

The drawing shows a cross-section of a concrete barrier (Schranke A1) without a sign. The barrier is 100 cm high and 184,498 cm long. It is connected to an existing pavement (vorh. Gehweg mit Doppel-T-Pflastersteinen) and a concrete monolith (Einbau Betonmonolith). The monolith is 100 cm high and 184,503 cm long. The barrier is made of concrete (Große Bauform, Typ 1) with a thickness of 0,90 m. The drawing also shows a 0,12 (Z295) reinforcement bar and a 0,90 m dimension for the monolith base.

Schranke A2 - QII/QIII  
Fa. Railbeton

Schranke ohne Behang (Länge 3-6 m)

Einbau Betonmonolith  
(Große Bauform, Typ 1,  
t = 0,90 m)

vorh. Gehweg mit  
Doppel-T-Pflastersteinen

184,435  
0,12 (Z295)  
184,430  
1,00  
0,90  
1,00

Einbau Betonmonolith  
(Kleine Bauform,  
t= 1,30 m)

vorh. Gehweg mit  
Doppel-T-Pflastersteinen

Technical drawing showing the installation of a traffic light (S2/S4, L2/L4) on a concrete monolith. The monolith is embedded in a concrete slab (Einbau Betonmonolith) with a height of 1,30 m. The traffic light is mounted on a pole with a height of 1,00 m. The concrete slab is made of double-T paving stones (Doppel-T-Pflastersteinen) and has a width of 0,70 m. The drawing also shows the dimensions of the concrete monolith (1,00 m height, 0,35 m width) and the traffic light (0,12 m width, 0,30 m height).

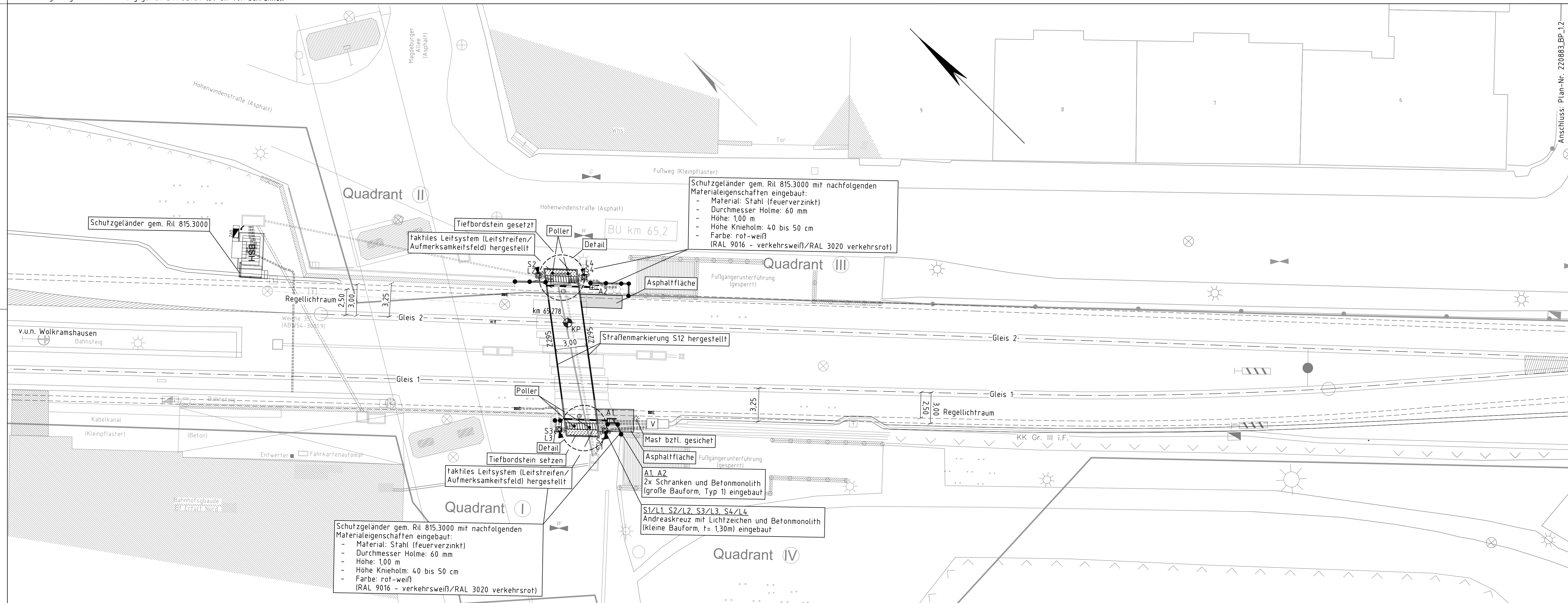
[illegible]

						Bestandsplan	
Ersatz für:				Ersatz durch:			
0							
6302.065,278							
Lageplan							
BUSA km 65,2 Erfurt Nord							
Strecke 6302 Wolframshausen - Erfurt Hbf.							
1,1	01				Blatt 1 von 2		